

# NANOCHEM<sup>®</sup> DOC<sup>™</sup> Particle Filter

## Features and Benefits

- Filtration for all applications from source to point-of-use
- Enhances manufacturing process economy and improves equipment performance
- **Versatile and upgradeable design**
  - Acts as stand-alone particulate filter
  - Allows future installation of BLOC<sup>®</sup> purifier
- No moving parts or power requirements
- Low Overall Cost of Ownership

## Specifications

- Recommended flow rates up to 20 slpm
- 0.003  $\mu\text{m}$  particle filter with 99.999999% retention (316L SS)
- Internal surface finish < 15  $\mu\text{in}$   $R_a$
- Maximum allowable working pressure of 150 psig (1.14 MPa)

## Connections

- Male inlet and outlet 1/4 inch, VCR<sup>®</sup>-compatible face seal fittings
- 1/4 inch tube stub connections for welded applications

## Overview

The NANOCHEM<sup>®</sup> DOC<sup>™</sup> filter is an ultra-high purity particle filter that also functions as a mounting station for optional NANOCHEM<sup>®</sup> BLOC<sup>®</sup> Purifiers.

- Accepts 50, 100 and 200 ml field interchangeable and replaceable BLOC<sup>®</sup> Purifier canisters
- Particulate filtration in a foot-print of only 2.11 inches (53.6 mm) with tube connections and 3.31 inches (84 mm) with VCR<sup>®</sup>-compatible face seal connections
- All metal parts, Type 316L stainless steel or Nickel 200
- All metal Z-Seal<sup>™</sup> between body pieces

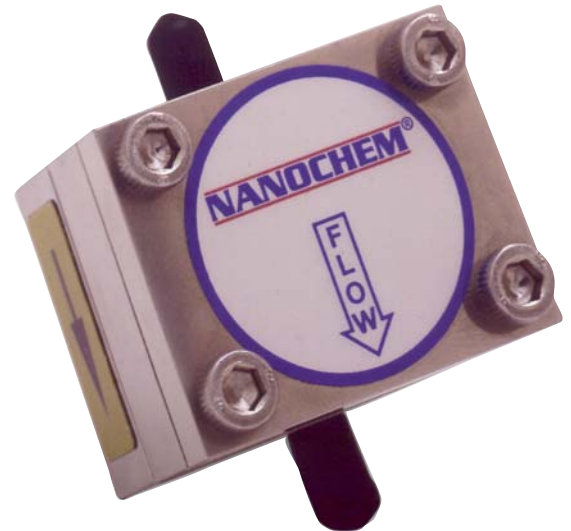

Pressure Drop vs. Flow Rate  
(DOC<sup>™</sup> Only)

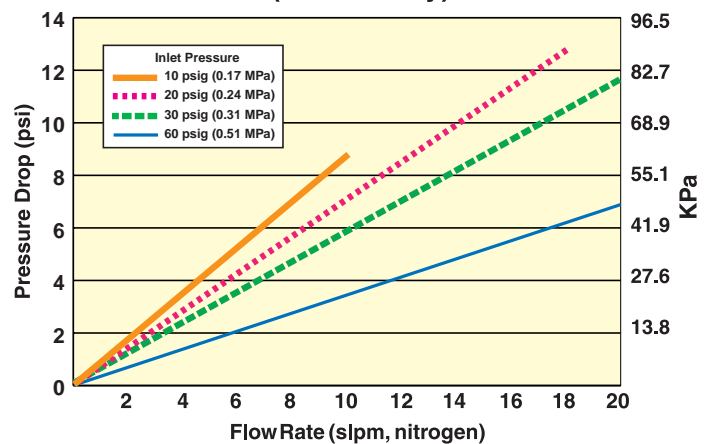

**MATHESON  
TRI•GAS**

ask...The Gas Professionals<sup>™</sup>

# NANOCHEM® DOC™ Particle Filter

All dimensions are in inches (mm)

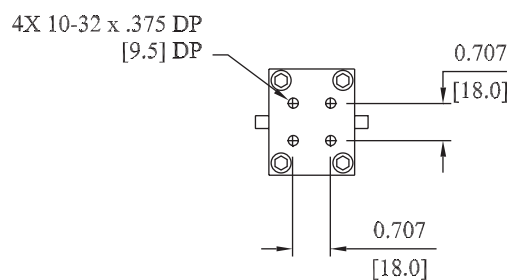
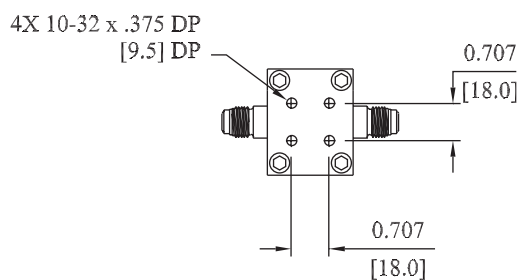
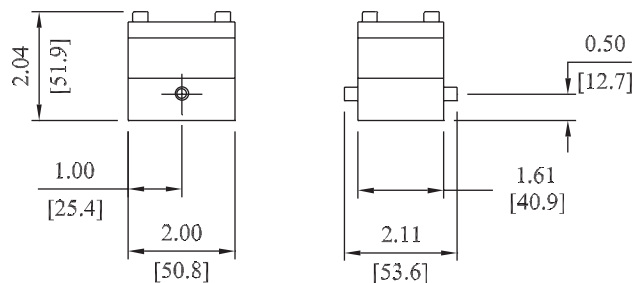
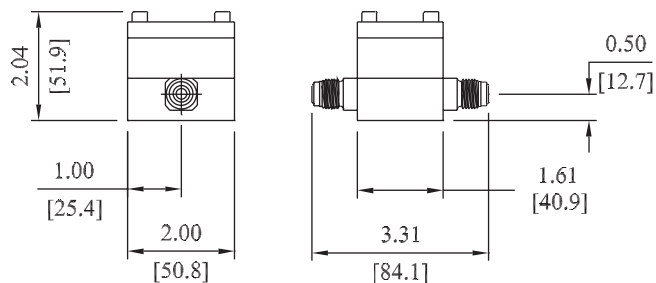
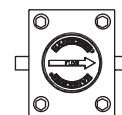
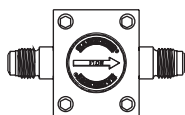

**DOC™ Filter with VCR®-Compatible Connections**

**DOC™ Filter with Tube Stub Connections**

Equipment Technology Center  
 166 Keystone Drive  
 Montgomeryville, PA 18936  
 Tel: 800-828-4313 • Fax: 215-619-0458  
 Email: Info@matheson-trigas.com

Specifications are subject to change. Please check [www.mathesontrigas.com](http://www.mathesontrigas.com) for most current information.  
 MATHESON TRI-GAS, NANOCHEM and BLOC are registered trademarks of Matheson Tri-Gas, Inc.  
 DOC is a trademark of Matheson Tri-Gas, Inc.  
 VCR is a registered trademark of Cajon Corporation. Z-Seal is a registered trademark of Unit Instruments, Inc.  
 Printed in USA PB024 R1/05



**MATHESON  
 TRI•GAS**

ask. . .The Gas Professionals™